



# Digital Brightness Sensor

**RL3**

**specification**

# Update Record

---

No.	Version	Remark	Date
1	Ver.1.0	Initial Release	2020.03.20

Note: The document is subject to change without prior notice.

Shanghai Xixun Electronics Co., Ltd.

# Product Picture

---



# Features

---

**RL3 is an accessory brightness sensor with the following features:**

1. Sensing the brightness of the current environment, according to the ambient brightness, automatically adjust the brightness of the display;
2. Standard 1.5m line, can be customized if customers have special needs;
3. Connect the sending card to use;
4. Can be used outdoors, three-proof;
5. Digital brightness sensor, higher adjustment accuracy.

# Technical Parameter

---

Probe Length (mm)	27
Hole Diameter (mm)	11
Test Accuracy (%f.s.)	±4.5
Test Range (Lux)	0-192000

Shanghai Xixun Electronics Co., Ltd

# Dimensions

---

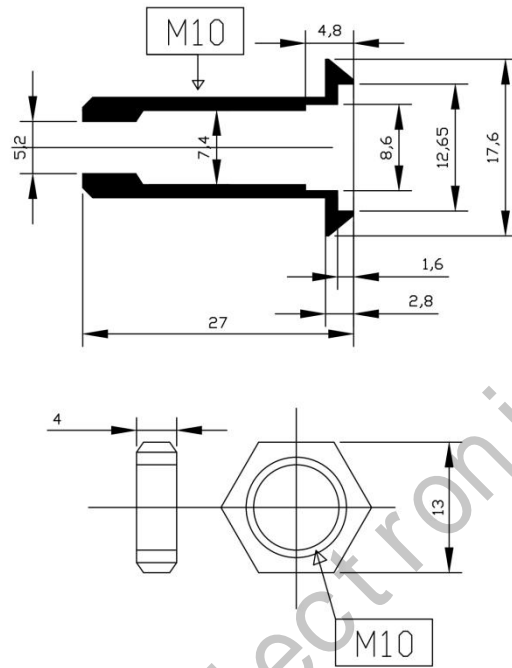

Unit: mm

# Cautions

---

1. Pay attention to waterproof.
2. Do not touch the chips and pins on the product to avoid electrostatic damage.



Shanghai Xixun Electronics Co., Ltd.